

GPS MARK LOCATIONS FOR RELOCATED CRBA OLYMPIC CIRCLE
COORDINATES SHOWN ARE WGS84 (NAD83)

MARK ID	A	B	C	D	E	F	G	H	Start / Finish S/F
DIRECTION	SE	E	NE	N	NW	W	SW	S	
MAG BRG	135	090	045	000	315	270	225	180	
Latitude	30°38'58"	30°39'19"	30°39'41"	30°39'51"	30°39'44"	30°39'24"	30°39'02"	30°38'51"	30°39'21.2"
Longitude	95°05'34"	95°05'22"	95°05'30"	95°05'54"	95°06'19"	95°06'31"	95°06'23"	95°06'00"	95°05'56.7"

Basis of Coordinates: Grid Convergence = -1.086Deg W; Declination = +3.5833 Deg E; GN to MN = 4.667 Deg

Olympic Circle = 1.00 Nautical Miles in Diameter

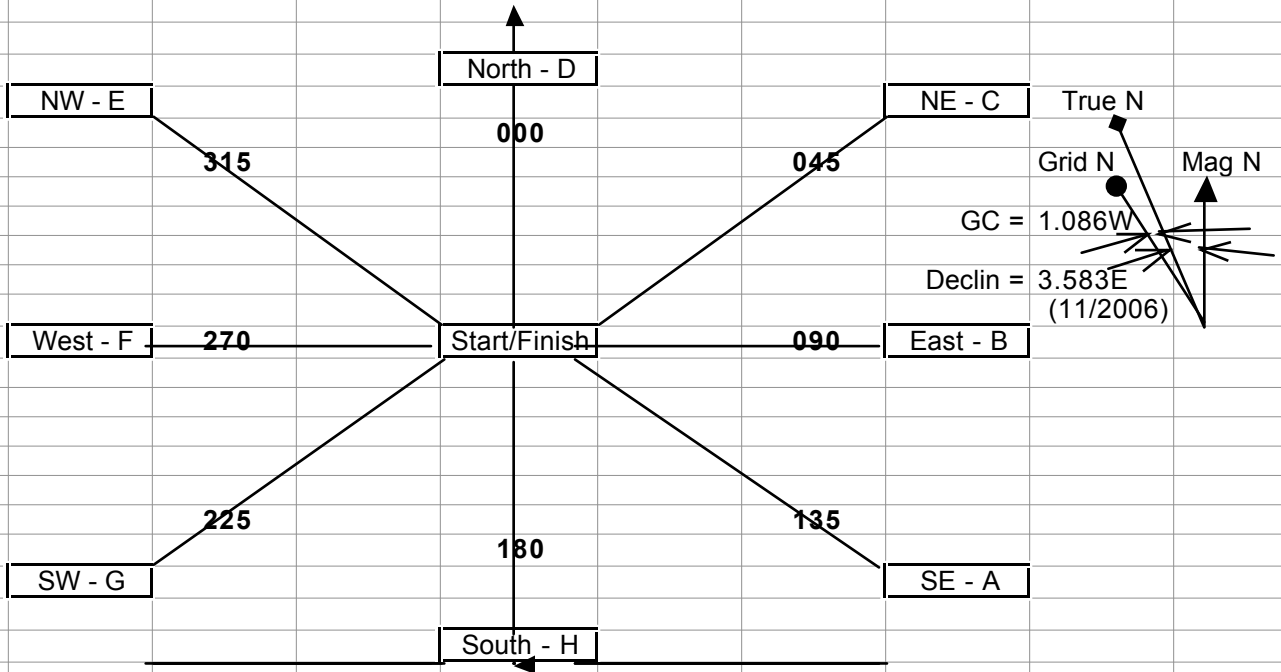

DECIMAL LAT & LONG

MARK ID	A	B	C	D	E	F	G	H	Start / Finish S/F
DIRECTION	SE	E	NE	N	NW	W	SW	S	
MAG BRG	135	090	045	000	315	270	225	180	
Latitude	30°38.967'	30°39.317'	30°39.683'	30°39.850'	30°39.733'	30°39.400'	30°39.033'	30°38.850'	30°39.350'
	30.64944	30.65528	30.66139	30.66417	30.66222	30.65667	30.65056	30.64750	30.65583
Longitude	95°05.567'	95°05.367'	95°05.500'	95°05.900'	95°06.317'	95°06.517'	95°06.383'	95°06.000'	95°05.933'
	-95.09278	-95.08944	-95.09167	-95.09833	-95.10528	-95.10861	-95.10639	-95.10000	-95.09889

Last marks ('C' & 'G') installed 9 3 07